

Distribución en planta e cotas

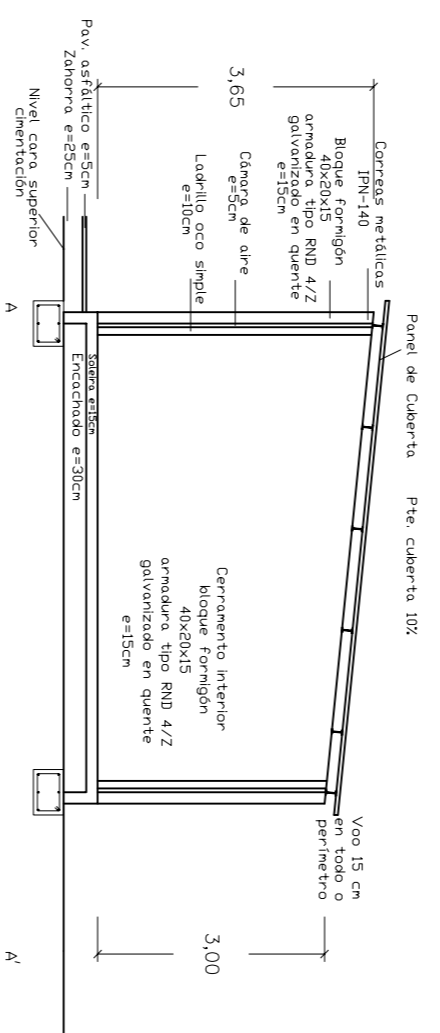

Sección esquemática A-A

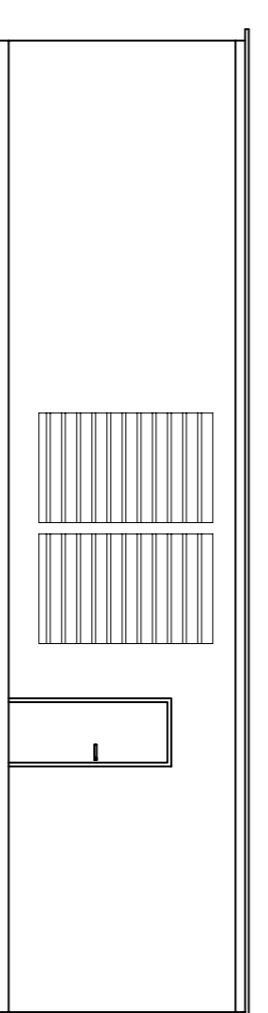

Alzado frontal

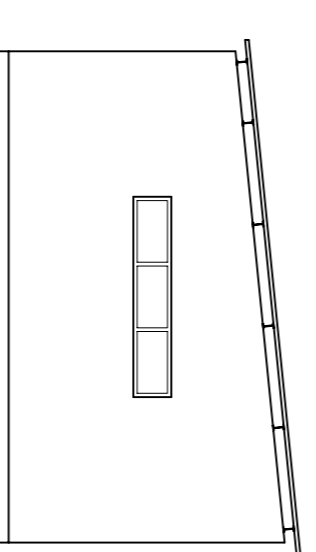

Alzado lateral dereito

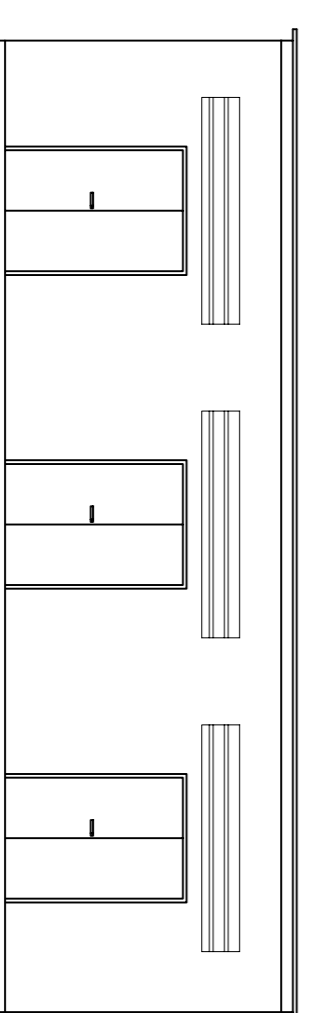

Alzado posterior

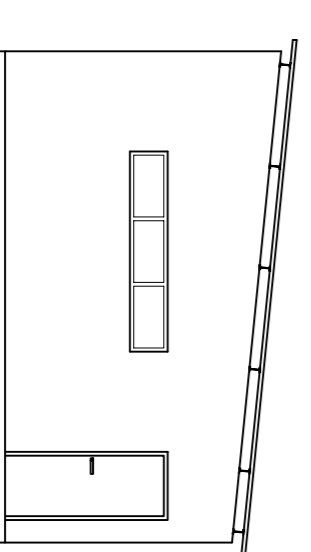



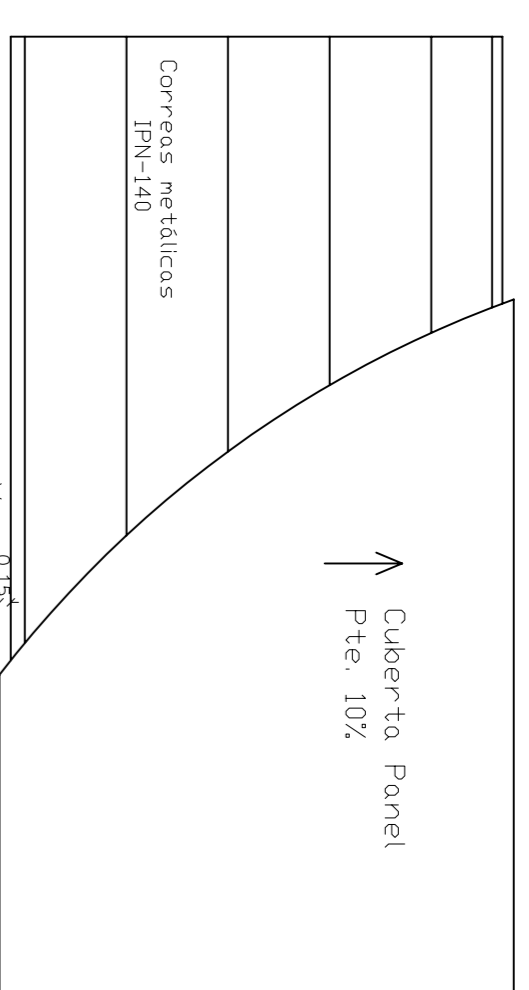

Alzado lateral esquerdo

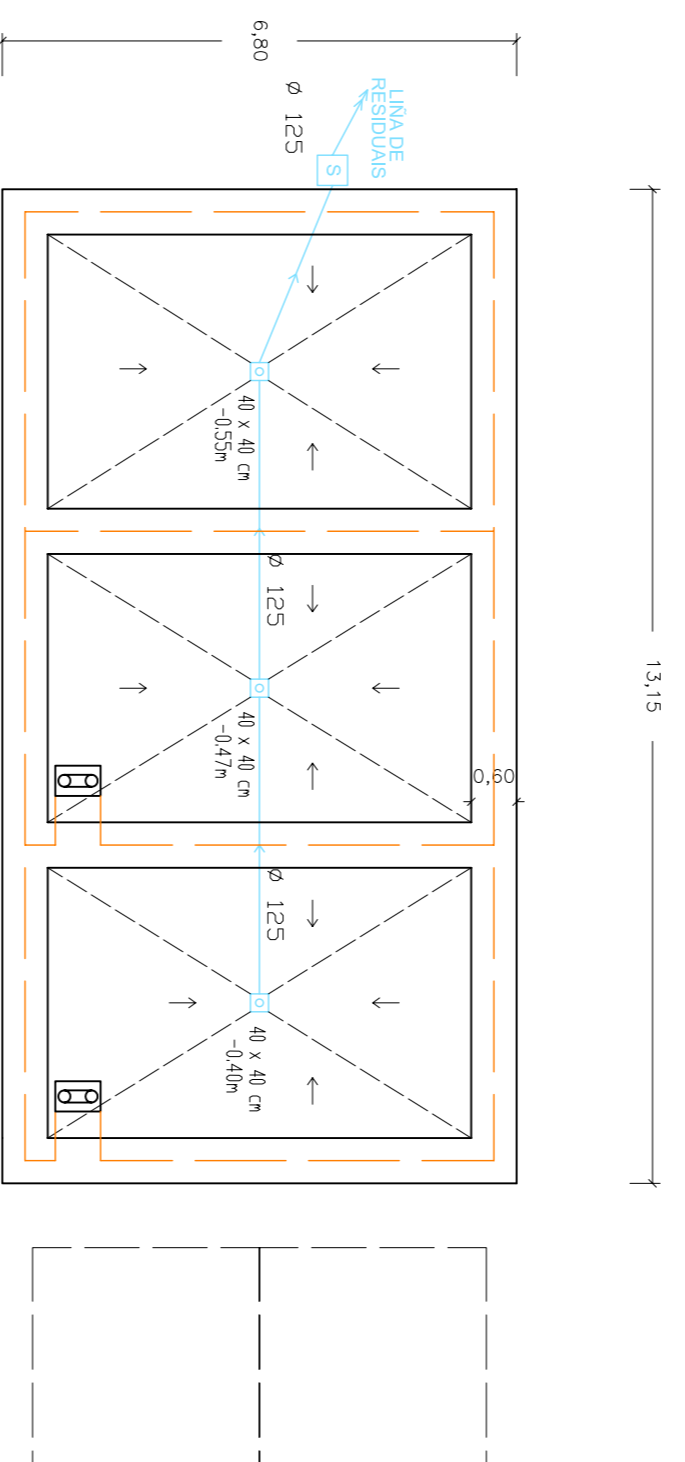

Cuberta



Cimentación, saneamento e posta a terra

-  Arqueta con saneliro sifónico PP
-  Arqueta de acero 100 x 100 mm
-  Arqueta sifónica
-  Tubaría PVC Ø125

Cimentación	
60 cm	Arq. sup. 3 Ø16
10 cm	Arq. inf. 3 Ø16
	Estrados 100 x 100
	data en cm

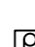
LENDA POSTA A TERRA	
SÍMBOLO	DESCRIPCIÓN
	Conductor de cobre esfolio de 35 mm ² , con 7 filos
	Arqueta de posta a terra

	Título: LABORATORIO AGROALIMENTARIO NA FINCA MOURISCADÉ	Data: Xaneiro 2010
	Situación: Mouriscadé – Vianova – Laitín (Pontevedra)	
O Enxeñeiro Agrónomo: Asdo. Alejandro Sánchez de Dios	Designación: EDIFICIO DE INSTALACIONES	Empresa consultora: 